



SSA001N  
Di.Pa. Sport REAR AIR SPRING  
CITROEN PICASSO (C4)



**WARNING:** The air suspension system is under pressure (up to 10 bar, or 150 lbf/in). Verify pressure has been relieved and disconnect power to the air suspension system prior to disassembly. Do not allow dirt or grease to enter the system. Always wear standard hand, ear, and eye protection when servicing the air suspension system.



SSA001N  
Di.Pa. Sport REAR AIR SPRING  
CITROEN PICASSO (C4)

GENERAL INFORMATION:

- Not to be stored below 5 °F (-15 °C) or above 122 °F (50 °C).
- Avoid damage to air lines and cables.
- Removal and installation is only to be performed by fully qualified personnel.
- Use car manufacturer's diagnostic software.

CAUTION: *Damage to the vehicle and air suspension system can be incurred if work is carried out in a manner other than specified in the instructions or in a different sequence.*



To avoid the possibility of short circuits while working with electric components consult your owner's manual on how to disconnect your battery.



Consult your vehicle owner's manual, service manual, or car dealer for the correct jacking points on your vehicle and for additional care, safety and maintenance instructions. Under no circumstances should any work be completed underneath the vehicle if it is not adequately supported, as serious injuries and death can occur.

AIR SPRING REMOVAL

1. RAISE THE VEHICLE.
2. REMOVE THE APPLICABLE REAR WHEEL, AS NEEDED FOR ACCESS.
3. LOCATE AND REMOVE THE COMPRESSOR PROTECTIVE COVER.
4. LOCATE AND REMOVE THE AIR LINE CONNECTION AT THE VEHICLES COMPRESSOR ASSEMBLY TO DEFLATE THE APPLICABLE AIR SPRING. (FIGURE 1)



FIGURE 1



SSA001N  
Di.Pa. Sport REAR AIR SPRING  
CITROEN PICASSO (C4)

5. LOCATE THE AIR SPRING. (FIGURE 3)



FIGURE 3

6. DISCONNECT THE AIR LINE BY PUSHING INWARD ON THE CONNECTOR SURROUNDING THE HOSE WHILE SIMULTANEOUSLY PULLING THE HOSE OUTWARD. (FIGURES 4, 5)



FIGURE 4



FIGURE 5

7. REMOVAL COMPLETE.



SSA001N  
Di.Pa. Sport REAR AIR SPRING  
CITROEN PICASSO (C4)

AIR SPRING INSTALLATION



*Tighten all nuts and bolts to manufacturer's specifications during the installation process.*

1. OBTAIN THE NEW ARNOTT SPRING. (FIGURE 6)



FIGURE 6

2. CONNECT THE AIR LINE AT THE TOP OF THE AIR SPRING, AS PER THE FOLLOWING SUB-STEPS.  
(FIGURE 7)

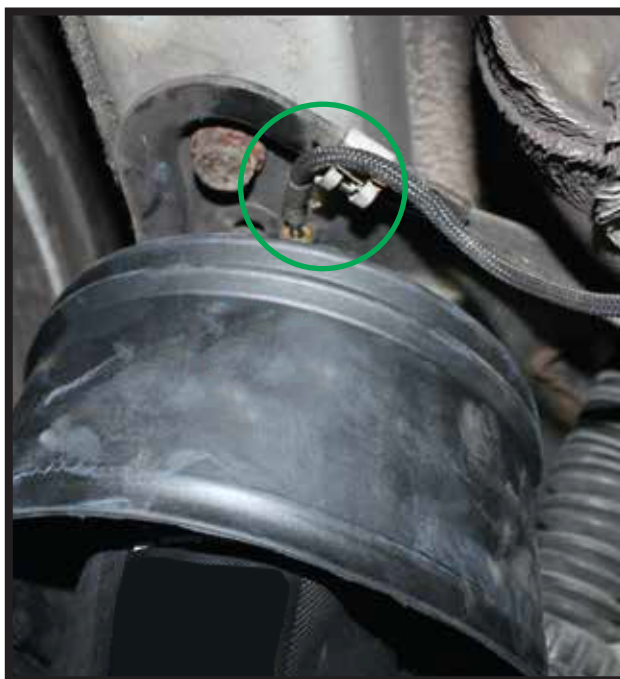
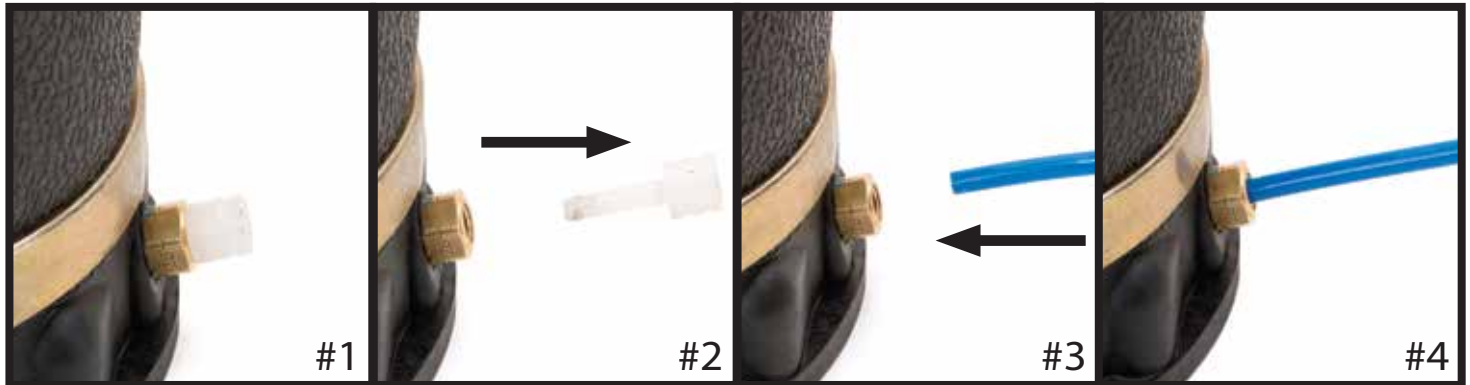

FIGURE 7



SSA001N  
Di.Pa. Sport REAR AIR SPRING  
CITROEN PICASSO (C4)

INSTALLATION



AS RECEIVED

REMOVE & DISPOSE OF  
SHIPPING PIN

INSERT THE AIR LINE INTO  
THE FITTING AND PRESS  
UNTIL FIRMLY SEATED

WITH THE AIR LINE INSERTED,  
PULL AIR LINE OUTWARD TO  
LOCK AND ENSURE A SECURE  
CONNECTION

3. RAISE THE REAR AXLE OR REINSTALL THE TIRE AND LOWER THE VEHICLE.  
ENSURE THE AIR SPRING IS PROPERLY SEATED PRIOR TO INFLATING. (FIGURE 8)



FIGURE 8





SSA001N  
Di.Pa. Sport REAR AIR SPRING  
CITROEN PICASSO (C4)

4. REATTACH AIR LINE TO COMPRESSOR ASSEMBLY AND REINSTALL PROTECTIVE COVER.  
(FIGURE 9)



FIGURE 9

5. INSTALLATION COMPLETE.